

VGP PUSHPA NAGAR EXTENSION - III

LAYOUT OF HOUSE SITES IN SURVEY NUMBERS : 235/2B1, 235/2B2A, 235/2B2, 235/1B,
MEDAVAKKAM VILLAGE, SHOLLINGANALLUR TALUK,
KANCHEEPURAM DISTRICT.

CMDA Approved No : 776,778,797,794,775,774,791,788/2016



235/1A1A1B

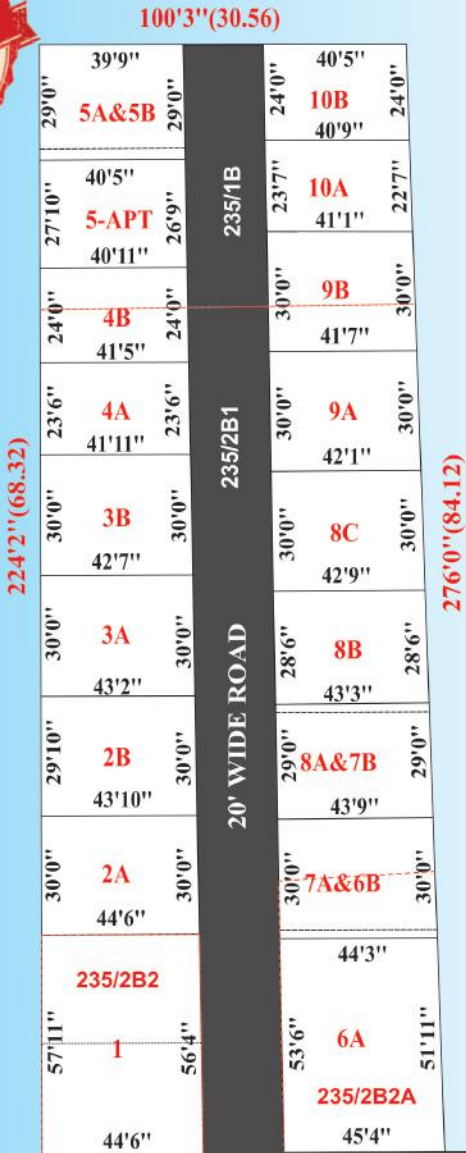

235 Part

AREA STATEMENT

PLOT No	EXTENT.Sqft
1B	2569
2A	1325
2B	1301
3A	1286
3B	1266
4A	979
4B	989
5-APT	1107
5-APT & 5B	1164
6A	2361
7A&6B	1320
8A&7B	1262
8B	1226
8C	1272
9A	1254
9B	1240
10A	946
10B	974

Distance From

- ❖ 5 Mins From Sholinganallur
- ❖ 10Mins From Velacherry (MRTS)
- ❖ 10 Mins From Tambaram Railway Station
- ❖ 15 Mins From 85Acres New Bus Terminuses (Vandalur)

Schools In Vicinity

- ❖ Velammal New Gen School
- ❖ San Academy
- ❖ Akshayah Matriculation School
- ❖ American International School

Colleges Nearby

- ❖ Bharath University
- ❖ VIT University
- ❖ Quaid E Milleth College
- ❖ New Prince College
- ❖ S.I.V.E.T College



Near by Healthcares

- ❖ Global Hospital
- ❖ Kamachi Hospital



EXISTING 30' WIDE ROAD

We Make Living Better
We Make Living Better
We Make Living Better